

甘蔗街道12.24亩工业用地 2894.8-40412.6

40412.58 2895.18 40412.83 2895.18

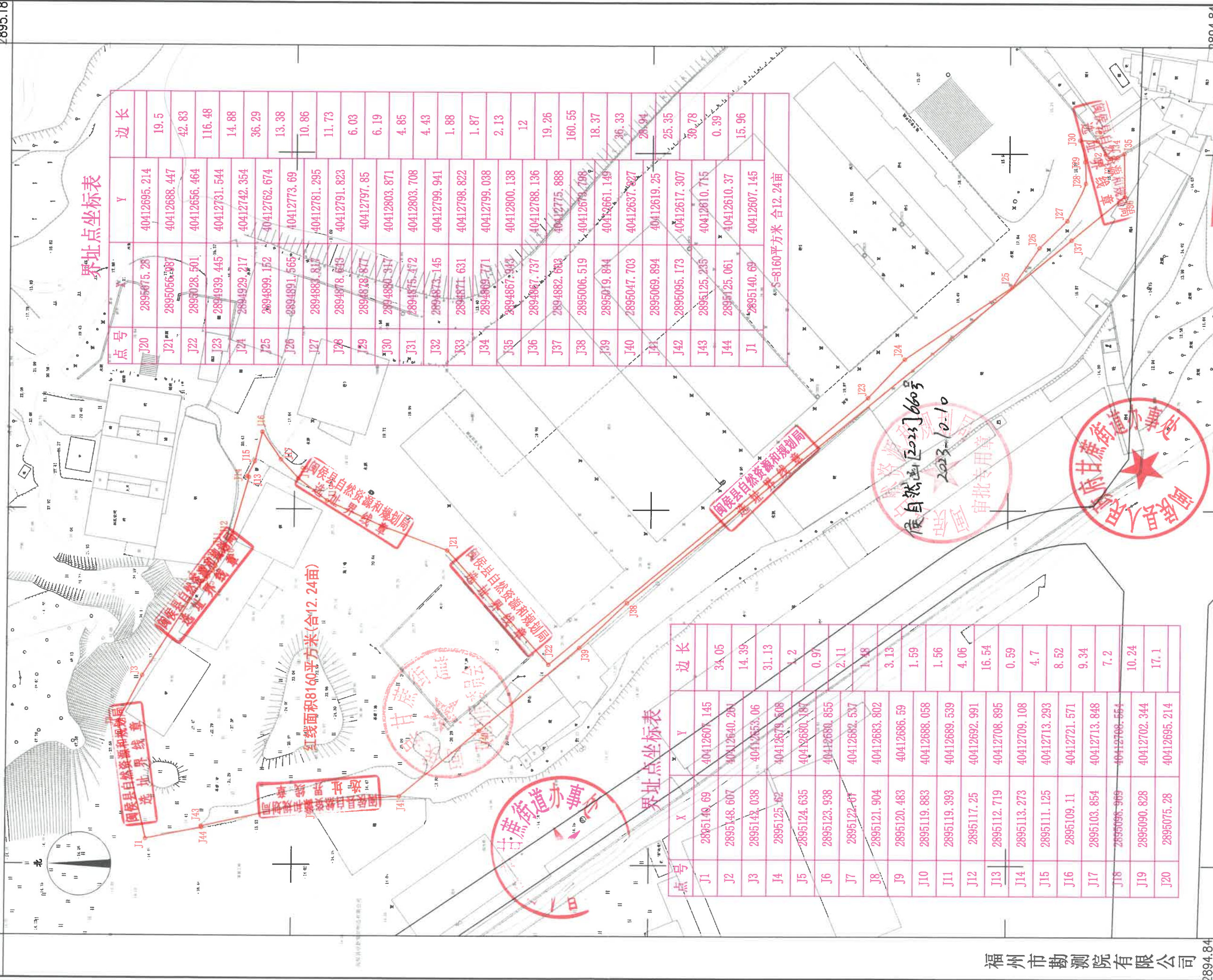

界址点坐标表

点号	X	Y	边长
J20	2895075.28	40412695.214	19.5
J21	2895056.387	40412688.447	42.83
J22	2895028.501	40412656.464	116.48
J23	2894939.445	40412731.544	14.88
J24	2894929.217	40412742.354	36.29
J25	2894899.152	40412762.674	13.38
J26	2894891.565	40412773.69	10.86
J27	2894883.817	40412781.295	11.73
J28	2894878.643	40412791.823	6.03
J29	2894876.877	40412797.85	6.19
J30	2894880.917	40412803.871	4.85
J31	2894875.472	40412803.708	4.43
J32	2894873.145	40412799.941	1.88
J33	2894871.631	40412798.822	1.87
J34	2894869.771	40412799.038	2.13
J35	2894867.943	40412800.138	12
J36	2894867.737	40412788.136	19.26
J37	2894882.683	40412775.888	160.55
J38	2895006.519	40412679.798	18.37
J39	2895019.844	40412661.149	36.33
J40	2895047.703	40412637.827	28.94
J41	2895069.894	40412619.25	25.35
J42	2895095.173	40412617.307	30.78
J43	2895125.235	40412810.715	0.39
J44	2895125.061	40412610.37	15.96
J1	2895140.69	40412607.145	

界址点坐标表

点号	X	Y	边长
J1	2895140.69	40412607.145	34.05
J2	2895148.607	40412640.261	14.39
J3	2895142.038	40412653.06	31.13
J4	2895125.82	40412679.308	1.2
J5	2895124.635	40412680.187	0.97
J6	2895123.938	40412680.855	2.11
J7	2895122.67	40412682.537	1.48
J8	2895121.904	40412683.802	3.13
J9	2895120.483	40412686.59	1.59
J10	2895119.883	40412688.058	1.56
J11	2895119.393	40412689.539	4.06
J12	2895117.25	40412692.991	16.54
J13	2895112.719	40412708.895	0.59
J14	2895113.273	40412709.108	4.7
J15	2895111.125	40412713.293	8.52
J16	2895109.11	40412721.571	9.34
J17	2895103.854	40412713.848	7.2
J18	2895098.969	40412708.554	10.24
J19	2895090.828	40412702.344	17.1
J20	2895075.28	40412695.214	

S=8160平方米 合12.24亩

福州市勘测院有限公司
测绘资质：甲 40412.83

证书编号：闽测字第 黄高明 075
绘图员：林配榕
发证机关：福建省自然资源厅

福州市勘测院有限公司

40412.58

2023年1月全野外数字化采集。
CGCS2000坐标系，中央子午线120°。
罗零高程系，等高距为1米。2017版图式。

1:1000